

SOLAR SECURITY  
**CAMERA**

[QUICK START →](#)

# OVERVIEW

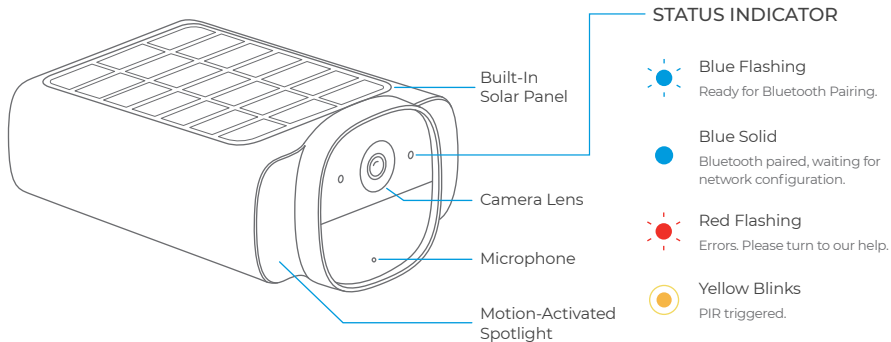

## BOTTOM VIEW

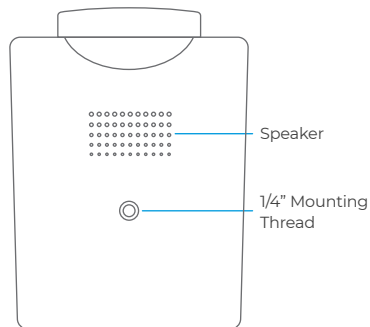

## BACK VIEW

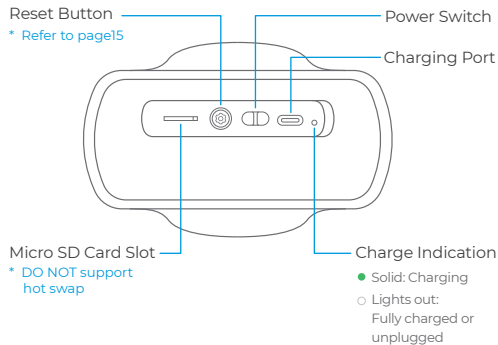



## **SECURITY AT HOME & BEYOND**

Changing how the world thinks about security  
inside & out!



# QUICK SETUP

## 1 DOWNLOAD THE APP

Scan the QR Code on the right, or search **Helio Pro** in the Apple App Store or Google Play Store. Create an account in the App, or login if you already have one.

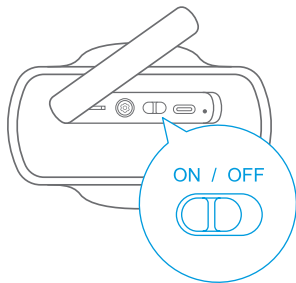

## 2 CHARGE AND POWER ON

⦿ Please charge the camera first with the included USB-C charging cable.

The camera will automatically go into Bluetooth connection mode when powering on, with a beep and blue flash of the indicator.

Please add it within the next 5 minutes, or it will enter battery saving mode (You can turn off and turn on the camera again to restart).

### 3 ADD THE CAMERA

Open the Helio Pro App, click the **TAP TO SCAN** button on the homepage (the regular add portal is at the bottom of the Settings page), and then scan the QR code on the camera with your phone.

The App will list devices scanned by Bluetooth. Click to connect, the camera will beep and the indicator will switch to blue solid.

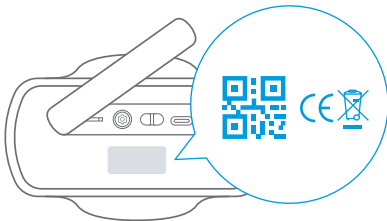

### 4 CONNECT TO WI-FI

Select the Wi-Fi (2.4 GHz) network you want connect the camera to and enter your Wi-Fi password. After successfully configuring the network, the camera will beep and the indicator light will go out.

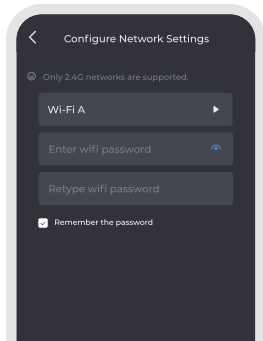

## 5 PLACE THE CAMERA

- In order to make full use of solar panel, please try to choose a place where the solar panel will receive maximum sunlight.
- To reduce frequent triggering of the PIR sensor: **AVOID** facing areas with strong light, temperature changes rapidly or the air stream flows frequently; **AVOID** facing high-traffic areas.
- Make sure the signal strength is great at the desired location.

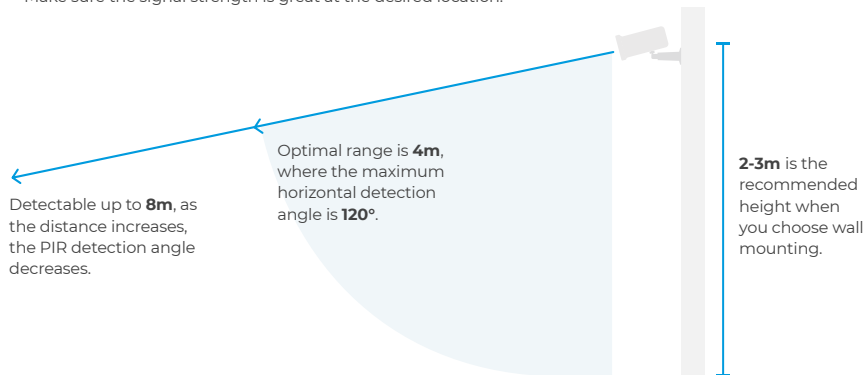

- Wall Mounting

1. Turn the knob of the mounting bracket counter-clockwise to loosen and disassemble it.

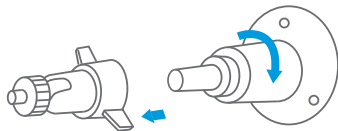

2. Place the mounting bracket against the wall. Drill holes with a 15/64 inch (6mm) drill bit, then insert the anchors into the holes.

© Anchors are necessary for walls that are made out of hard materials such as concrete, brick, or stucco.

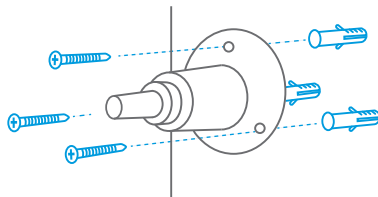

3. Firmly screw the knob of the mounting bracket into the mounting hole of camera.

© For better performance, please remove the protective film from the front of the lens before use.

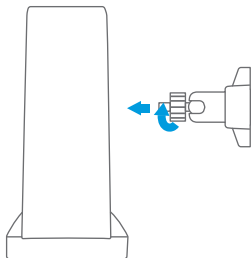

4. Hold and screw camera to the mounting bracket. Rotate camera to adjust the view and check it using the live stream which you can access in the [Alphahom](#) App.

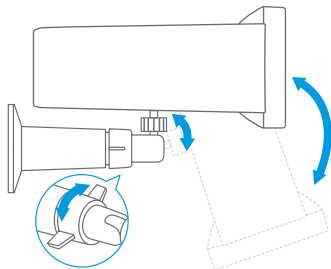



## Setup Completed!

Now feel free to explore the many App Features.

# APP FUNCTIONS



Customize the homepage: Swipe up and tap **EDIT** on the top of the floating layer.

Shown here is the Cameras-Only Mode. You can also use it with the Alphahom Smart Security System for full protection of your home.

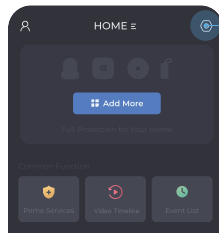

All of your devices can be found under Settings

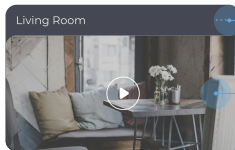

Camera Settings

Start Live View  
\* Refer to page12



# LIVE VIEW

» Collapse/Expand secondary toolbars.



Turn off the Spotlight.



Turn on the Spotlight.



Emit a Flashing Alarm.



Emit a Audible&Flashing Alarm.



Turn on/off the sound of the video.



Enable Two-way Audio.



Switch to the Multiple Screens View.



Switch the HD/SD Display of live streams.



Tap to take a screenshot.

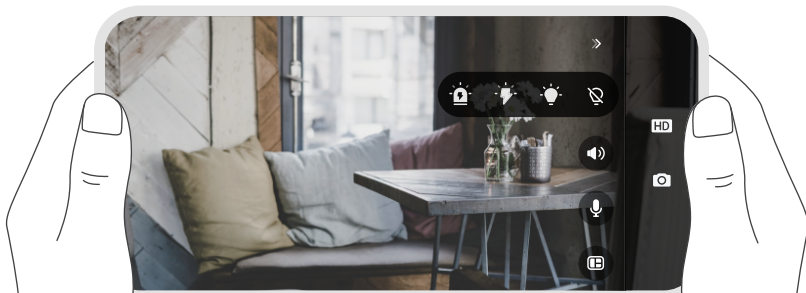



# HOW DOES MOTION DETECTION WORK?

## PIR Detection

It triggered by objects with a heat source such as humans, animals, cars, even hot/cold air. With AI detection, humans can be identified.

The camera generates 15s of video per trigger, and can be re-triggered after a 10s cooldown.

## Records & Notifications

Consecutive triggers only generate one App push to avoid frequent disturbances.

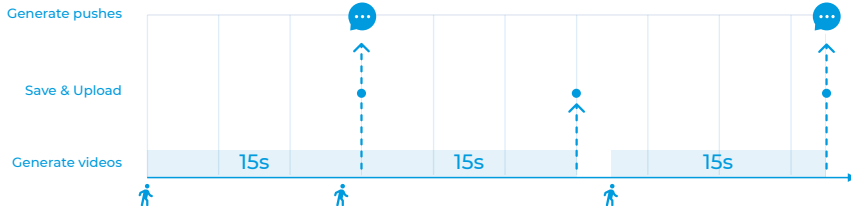

# HOW TO EXTEND THE BATTERY LIFE?

## Set a reasonable motion detection time:

To reduce the power consumption caused by the camera being woken up frequently.

\* [Camera Settings](#) → [Motion Detection](#) → [Detection Conditions](#)

## Set the appropriate detection accuracy:

If the detection accuracy is set to HIGH, the AI recognition process will increase power consumption.

\* [Camera Settings](#) → [Motion Detection](#) → [Detection Accuracy](#)

## Reduce App usage time:

The system waking up camera each time the App is launched also increases power consumption.

---

According to experimental data, the camera can provide approximately 6 months of standby time with less than 5 triggers per day.

# HOW TO RESET THE CAMERA?

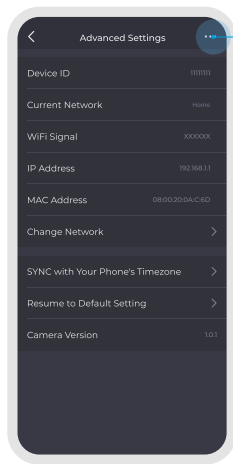

## Reset on the App

When the camera is **ONLINE**, tap here to reset. After resetting, all data will be deleted and the camera will reboot, allowing you to add it as new.

When the camera is **OFFLINE**, tapping here will only delete it. After deletion, the camera will be unbundled from the family. However the hardware is not reset. To add it again, you need to reset on the camera as on the right.

## Reset on the Camera

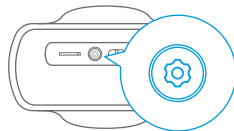

Open the cap at the bottom of the device and hold the **RESET BUTTON** for 5 seconds until you hear a beep. After resetting, all data will be deleted and the camera will reboot, allowing you to add it as new.

# FEATURES



## AI Motion Detection

You can customise detection accuracy to filter invalid alarms such as vehicles, animals, trees, rain&snow, etc.



## 1080P Full HD

Full HD 1920 x 1080 pixels and 15fps frame rate give you crystal clear and smooth images. The wide-angle lens also provides a larger field of view.



## H.265 Encode

The new generation of H.265 video coding technology can save video storage space and make view smoother under the same network conditions.



## Wi-Fi Connection

IEEE 802.11 b/g/n compliant WiFi standard, 2.4GHz frequency range, support WEP, wpa-psk and wpa2-psk encryption.



## Cloud Backup

You can purchase the Video Cloud Service in the app according to your needs.



## Real Two-way Audio

In the App live monitoring view, you can press and hold the  button to talk to the monitored area.



### Motion-Activated Spotlight

When a dormant camera is awakened by motion detection, it will automatically turn on the floodlight if there is not enough light (needs to be enabled in the Camera Settings).



### Sound & Light Warning

A flash light and high-volume alarm can be triggered via the App's liveview, to scare off any unwanted visitors.



### Integrated Solar Power

Up to 1.3W charging power with built-in solar panel to maintain daily power requirements in sunny outdoor conditions. Type-C charging is also available as a supplement.



### Military-grade encryption

Military-grade encryption is used for live streaming and video storage, and only accounts with user rights can decrypt videos.



### Global Servers

Global overseas servers ensure that users can easily watch real-time live broadcast or video playback anytime, anywhere on their mobile phones.



### Protection Rating IP66

It has an excellent ability to withstand harsh environments, as an outdoor camera. (IP66: Completely dust-proof and can withstand intense jets of water for at least 3 minutes.)

# PERMISSIONS & PRIVACY

		iOS	Android
Notification	Device information and system status messages can help you manage your device and protect your security.	✓	✓
Critical Alert	When your iPhone is in Silent or Do Not Disturb mode, you can still receive audible notifications of emergencies. <a href="#">Reference →</a>	✓	
Photos (iOS) / Storage (Android)	To access the album to add devices/families, or set avatar. To take screenshots or records of the monitoring screen.	✓	✓
Camera	To scan the QR code of devices/families, or set avatar.	✓	✓



		iOS	Android
Microphone (iOS) / Recording (Android)	To enable dual-way talking feature of cameras.	✓	✓
Location	To configure devices via Bluetooth and Wi-Fi (For Android, Location access is required to using Bluetooth.) <a href="#">Reference →</a>	✓	✓
Bluetooth	To configure devices via Bluetooth.	✓	
Contacts	To add SMS Contacts quickly.	✓	✓



# SPECIFICATIONS

VIDEO & AUDIO	
Image Sensor	1/2.9"
Resolution	Full HD 1920×1080
Video Bitrates	64Kbps ~ 8Mbps
Video Frame Rate	15fps @ 1080P
Encode	H.265/H.264
Full color night vision	600lm, 8M, 4000-4500K
Focal Length	2.8mm
Max Aperture	f2.2
Field of View	135°
Audio	Real Two-Way audio

DETECTION & ALARM	
AI Smart Detection	PIR detection + Human detection
PIR Sensitivity	High/Medium/Low three gears adjustable
PIR Detecting Angle	100°~120°
PIR Detecting Distance	6~8m
Audio Alert	Built-in Siren, 95dB
Other Alerts	Instant image/video push notifications
Recording	15s video record when triggered
Storage	Local Storage and Cloud Storage



WIRELESS CONNECTION	
WiFi	2.4 GHz
WiFi Standard	IEEE 802.11 b/g/n
WiFi Security	WEP/WPA-PSK/WPA2-PSK
Bluetooth	BLE 5.0
STORAGE	
Micro SD Card	Supported, up to 128GB
Cloud Storage	* Supported (Optional)
OPERATING ENVIRONMENT	
Operating Temperature	-10 ~ 60°C (-14 ~ 140°F)
Weather Resistance	IP66

POWER SUPPLY	
Battery	5200 mAh rechargeable battery
Power Input	5V = 2A USB Type-C (Compatible with QC/PD charging)
Charge time (0-100%)	4.5h (5V = 2A)
Solar Charging	Built-in solar charging panel, 1.3W Max
DIMENSION & WEIGHT	
Dimension	Camera: 140.7×107.3×68.1mm
Weight	Camera: 419.0g (Net weight)

# FCC STATEMENT

This device complies with Part 15 of the FCC Rules. Operation is subject to the following two conditions:

- This device may not cause harmful interference, and
- This device must accept any interference received, including interference that may cause undesired operation.

Warning: Changes or modifications not expressly approved by the party responsible for compliance could void the user's authority to operate the equipment.

NOTE: This equipment has been tested and found to comply with the limits for a Class B digital device, pursuant to Part 15 of the FCC Rules. These limits are designed to provide reasonable protection against harmful interference in a residential installation. This equipment generates uses and can radiate radio frequency energy and, if not installed and used in accordance with the instructions, may cause harmful interference to radio communications. However, there is no guarantee that interference will not occur in a particular installation. If this equipment does cause harmful interference to radio or television reception, which can be determined by turning the equipment off and on, the user is encouraged to try to correct the interference by one or more of the following measures:

- Reorient or relocate the receiving antenna.
- Increase the separation between the equipment and receiver.
- Connect the equipment into an outlet on a circuit different from that to which the receiver is connected.
- Consult the dealer or an experienced radio/TV technician for help.

## **FCC RADIATION EXPOSURE STATEMENT**

This equipment complies with FCC radiation exposure limits set forth for an uncontrolled environment. This equipment should be installed and operated with minimum distance 20cm between the radiator & your body.

L



Made in China

## **NOTIFICATIONS**

The individual parameters, digital description and design in the manual may vary as the device versions are updated.

Please observe the working rules of electrical equipment. Users are not allowed to dismantle the device or replace any part of it. Opening or dismantling the device may cause electric shock.

This device can minimize most of the risks, but it is not guaranteed to prevent burglary, robbery, theft or other types of emergencies. Users should use it reasonably and properly to protect the safety of life or property.

Motion detection: the device uses AI image recognition and heat source induction to improve the accuracy of motion detection and filter invalid alarms as much as possible. Users need to choose the appropriate mobile detection accuracy according to the monitoring site. This device can only detect intrusion in the designated scope and barrier free area, please install it in the position as far as possible.

Network failure, electrical system component failure and other problems may affect the operation of the device.